

MiB-1 Exterior Description

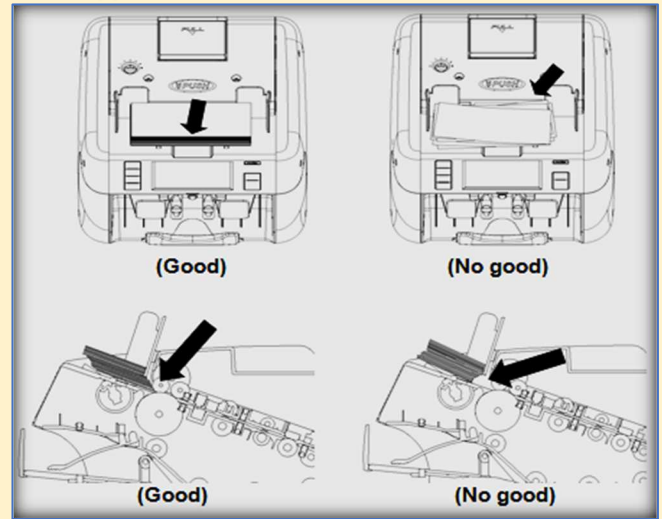

➤ Know how to place Banknotes onto Hopper correctly with Hopper Guides



- ① Align banknotes nicely on each edge and place them in the Note hopper.
- ② Adjust Note guides to the dimension of your banknotes.

➤ Know important keys on Control Panel



Select Counting Modes

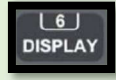

Detail counting results

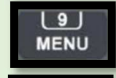

User- Menu setting



Print various results



Counterfeit Detection



Start / Stop / Enter



Auto / Manual Start

➤ How to activate ADD function?

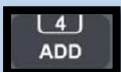

ADD key is located on the left side of the control panel with numeric key 4. ADD function is to provide a cumulative count of continuous operation (multiple stack or banknotes) of processing banknotes.

► It is a useful function when an operator has lot of Stacks of banknotes to count and accumulates them to Total count.

➤ How to change SPEED of Operation Modes?



[SPEED] key is located on the left side of the control panel with numeric key 1. **Three different counting speeds can be set for all discriminating modes (MIX / SINGLE / SORT / S-FACE / S-ORIENT)**, however, 1000 speed is default and best speed for higher recognition and less jamming.

► User can change COUNT mode (Piece count) from 800/1000/1200/1500 notes per minute, however, recommended speed is 1200.

➤ How to switch to different counting modes?



► Press **[MODE]** key to enter **MIX** → **SINGLE** → **SORT** → **S-FACE** → **S-ORIENT** → **COUNT** modes

Discriminating modes change in sequence every time the navigation key **[MODE]** is pressed:



→ **MIX** → **SINGLE** → **S-FACE** → **S-ORNT** → **SORT** → **COUNT**

➤ Overview of 3.5" LCD Display Screen:

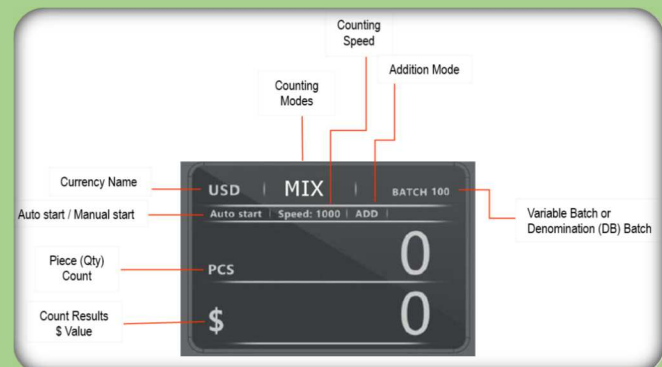

AMROTEC® MiB-1 OPERATOR'S QUICK HANDBOOK

➤ How to switch currency (USD+CAD currency is standard, USD is default)

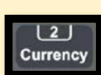

Press [Currency] Button on the left side of the Control Panel to view all loaded currency on the device in a separate screen. Select your desire currency by using navigation arrow keys and press START / STOP to save. Selected currency will show on the top left corner of the LCD Display screen. MiB-1 device can be loaded with optional 20 currency software.

➤ How to Auto-Print Receipt to a Printer?

User can set up Automatic printing of count result receipt by choosing Auto Printing ON. Machine will start printing as soon as banknotes are removed from Stacker.



Press **MENU** → 1. Service Menu → Password → 4. **AUTO PRINT** → **ON** (Only prints when Hopper is empty each time). to confirm your selection and exit.

➤ How to View Stacker count and denomination breakdown



▶ Press [DISPLAY] key on the control panel to view total stacker count and break-down of all currency denomination.

➤ How to switch to Multi-currency Count in mixture operation and process in a Single-Pass?

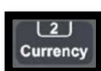

Press [Currency] on the Control Panel to view various choices on a separate screen. Select **"MULTI"** by using navigation arrow keys and press START / STOP to save. Now, device is ready to count and process multiple currencies in a single-run (for those are loaded into the device).

➤ How to set BATCH by Qty?



MiB-1 machine allows users to select counting of banknotes by a specific batch number (1-200) →

▶ Press [BATCH] Key followed by numeric keys (0-9) on the control panel to select your desire batch number and then press START / STOP key to confirm the selection. Use ESC Key to erase batch number.

➤ How to set and activate Denomination Batch (DB) for each denomination.



▶ To process each denomination of banknotes by a fixed pre-set batch number (only apply to SINGLE, and SORT Counting Mode).

▶ Setting: Switch mode to **SINGLE** or **SORT** and Press **BATCH** key → until **DB** appears on top right corner of the display screen. By default, all denominations are set to 100.

➤ How to enter into Denomination Batch (DB) setting for changes?

By default, all denominations are set to 100 under DB setting from factory. To make changes, enter into

➔ **4. Setting DB.**



▶ User can modify these batch number for each denomination manually and save into Machine software by pressing START/ENTER when changes are done.

▶ Changes can be made by using of numeric keys (0-9) and 4 navigation arrow keys.

DENOM	VALUE
100	100
50	100
20	100
10	100
5	100
2	100
1	100

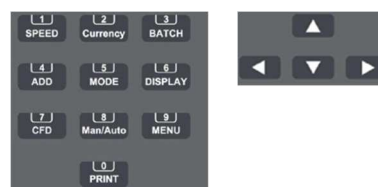

➤ Important Counting Modes and explanation:

▶ MIX (As Default Mode)

When Mix mode is selected, Machine will count and denominate mixture denomination of banknotes and halt in case of no-read or suspect banknote.

▶ SINGLE

Machine counts and sort first detected genuine banknotes as standard to Stacker and halt if meet with other denomination.

▶ SORT (for Organized Strap)

Machine processes organized denominations in a strap of banknotes (Strap banknotes from POS cash drawers).

▶ S-FACE (Face-Direction)

Machine delivers first detected Face of banknote to Stacker and halt when it sees mismatch face.

▶ S-ORIENT (Orientation)

Machine delivers first detected Face-up in one orientation of banknote to Stacker and halt when it sees mismatch of Face-orientation.

➤ How to perform Manual Entry Function for non-recognized genuine bills in reject pocket.

▶ During counting, if device stops at a genuine and good banknote for various reasons, user has option to recount the banknote or remove it to enter its denomination and value into running total.

▶ Press [ESC] key and when denomination screen appears, use navigation keys to select and use 10-keys to enter new value →



DENOM	PCS	USD AMOUNT
1	432	432
2	0	0
5	102	510
10	3	30
20	6	120
50	3	150
100	3	300

