

MIB-9 Exterior Description

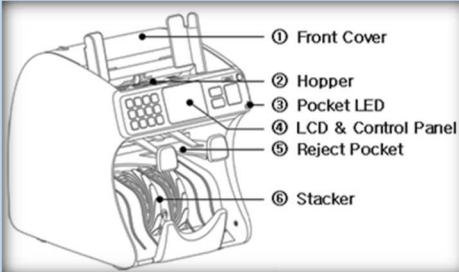

- 1) Front Cover
- 2) Hopper
- 3) Pocket LED
- 4) LED & Control Panel
- 5) Reject Pocket
- 6) Stacker
- 7) Currency Gate Adjustment Screw
- 8) Rear Cover Open handle
- 9) Power Switch
- 10) AC Inlet
- 11) RJ11 Port
- 12) LAN Port
- 13) RS232C Port (Serial)
- 14) USB Port
- 15) SD Card Slot

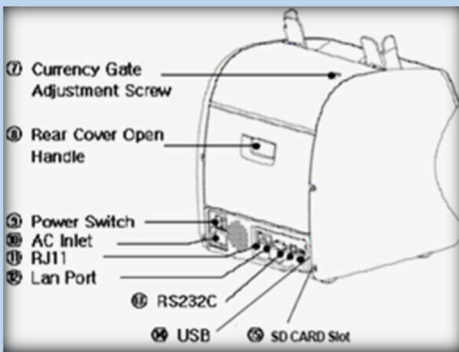

➤ Know how to place Banknotes onto Hopper correctly with Hopper Guides

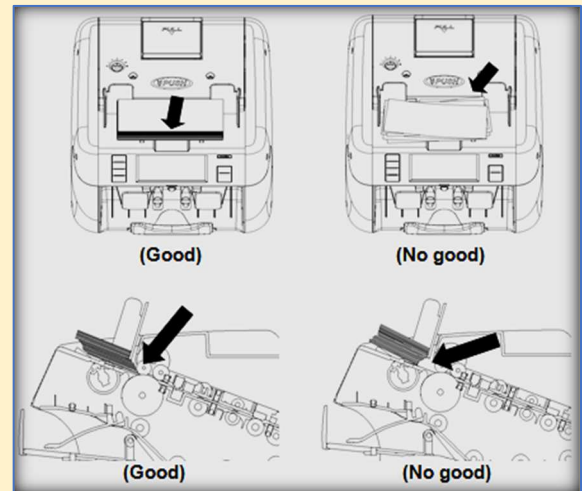

- ➊ Align banknotes nicely on each edge and place them in the Note hopper.
- ➋ Adjust Note guides to the dimension of your banknotes.

➤ Know important keys on Control Panel

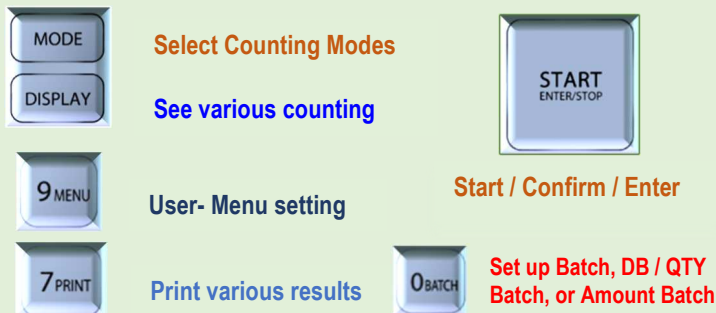

➤ How to switch to different counting modes?

➤ Press [MODE] key to enter into MIXED → SINGLE → SORT → FACE → ORIENT → DSP → COUNT → [You can remove some of these Counting Modes permanently from the User-interface if not needed for user's counting operation ►► simplicity].

*** Contact your Sales Rep to make this Change ***

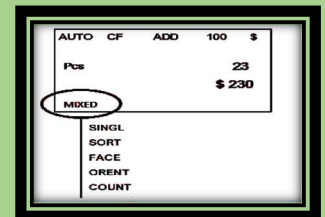

➤ How to select Automatic (Default) or Manual Count?

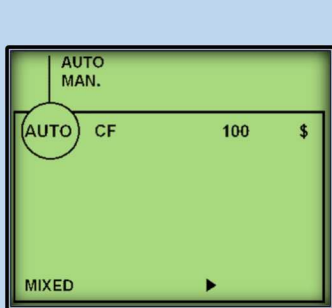

Press [MENU] key → USER MENU → 4. SETTING → 4. AUTO START (AUTO is Default).

If Manual Start is selected, top layer of the screen will show MAN.

➤ How to activate ADD function?

➤ ADD key is located on the LEFT side of the control panel with numeric key 2. ADD function is to provide a cumulative count of continuous operation (multiple stack or banknotes) of processing banknotes.

➤ How to switch to Multi-currency Count operation (if additional currency software is loaded)

Press this key on the control panel to switch from one currency to another, let's say USD to Canada bills and vice-versa. MIB-9 only processes one currency type each time.

➤ Important Counting Modes and explanation:

➤ MIXED (Mixture denominations)

When Mix mode is selected, Machine will count and denominate mixture denomination of banknotes and provide denomination total and break-down.

➤ SINGL (SINGLE)

Machine counts and delivers first detected genuine banknotes as standard to Stacker and delivers rest to Rejct Pocket.

➤ SORT (for Organized banknote denominations in a Strap)

Machine processes organized denominations in a strap of banknotes (Strap banknotes from POS cash drawers) and stop when a new denomination arrives.

➤ FACE (Face-Direction) & ORIENT [ORENT] (Face-Orientation)

Under FACE, machine delivers first detected Face to Stacker and deliver reverse to Reject Pocket. Under "ORENT", machine delivers first detected Face-up in one orientation to Stacker and deliver reverse to Reject Pocket.

➤ DSP (Quick Strap by dollar amount in single or mix)

Under DSP mode, strap by a specific dollar amount of single or mix bills.

➤ How to Auto-Print Receipt to a Printer?

User can set up Automatic printing of count result receipt by choosing Auto Printing ON. Machine will start printing as soon as banknotes are removed from Stacker. Press MENU key → USER MENU → 5. PC Interface → 1. SERIAL SET → AUTO PRINT → ON (choose after Empty Hopper)

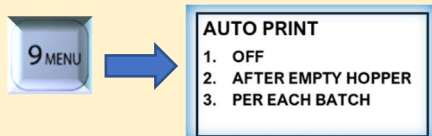

➤ How to set BATCH by Qty?

MIB-9 machine allows users to select counting of banknotes by a specific batch number (1-200) → Press **BATCH** key

▶ Use numeric keys (0-9) on the control panel and then press **START / ENTER** key on the right side of the control panel to confirm the input.

➤ How to View Stacker count and Grand Total?

▶ Press GT key on the control panel to view total stacker count and Grand Total. To accumulate all counts into G.Total, [PRINT] key must be pressed after every count.

▶ Press GT key → [DISPLAY] Key to view Grand Total details with denomination breakdown.

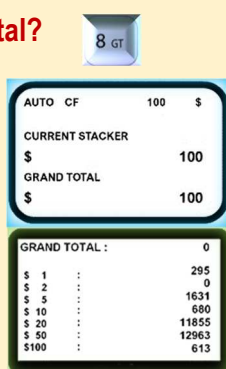

➤ How to set and activate Denomination Batch (DB) for each denomination (Batch by preset quantity)



▶ To process each denomination of banknotes by a fixed pre-set batch number (**DB Batch function only apply to SINGLE, and SORT Counting Mode**).

▶ **Setting:** While in **SINGLE** or **SORT** mode, Press **BATCH** key 2 times and (DB) will appear on top layer of the display screen activating denomination batch by qty. By default, all denominations are set to 100 qty which can be changed by users if desire. See on the right how to change factory default batch qty for each denominations.

➤ How to perform Manual Entry Function for non-recognized genuine bills in reject pocket.

REJ	1	COUNT	33
AMOUNT			155
\$ 1	10 (00)		10
\$ 2	0 (00)		
\$ 5	21 (01)		105
\$ 10	0 (02)		
\$ 20	2 (00)		40
\$ 50	0 (00)		
\$ 100	0 (00)		

▶ After a count is completed and if there are genuine banknotes rejected for non-recognition, prior removing bills from Reject Pocket, press [DISPLAY] key **twice** to reach to **Manual Entry input screen** (Detail View) where user can make the addition of those non-read banknotes and add to running total.

Press **START/ENTER** key to save your entry.

➤ How to Strap/Batch by Denomination Qty or by Amount

In **SINGLE** or **SORT** mode, press **BATCH** Key 3 times and the denomination screen will appear as below:



▶ **[ALL]:** Any number enter into [---] will apply to all denomination. Use arrow button to highlight [ALL]. Press [0] to 0 out ALL column first before next steps.

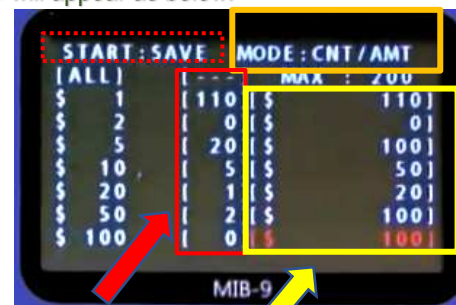

▶ Press **MODE** key to

▶ choose **CNT (QTY)** or **AMT \$**

▶ Use **UP(↑)** or **DOWN(↓)** key to shift from one denomination column to another and use [0] to [9] numeric keys on the control panel to enter your strap quantity or Amount. Once done, press **[START/ENTER]** key to save your desire settings by either all denomination Qty or Amount.

▶ Machine will return to main screen; Ready to process your new Strap by Qty or by Amount as pre-set for one or all banknote denominations.

➤ How to Strap all denominations by \$ amount & Total Amount

In **MIXED** mode, operators can set up any or all denomination banknotes **Strap by individual \$ amount and get a Total dollar (\$) count of all Straps**. This function calls "**MDB**" and activates by pressing **BATCH** key twice (until **MDB** appears) in **MIXED** mode.



▶ **Setting:** When in **MIXED** mode, press **BATCH** key 3 times to reach the denomination table as above (See DB setting table above) to set up dollar amount for denomination.

▶ Press **DOWN(↓)** to reach to **[\$1]** or any denominations.

▶ Press **[MODE]** key to change to **AMT** column and set up dollar amount for ALL or each denominations by using **numeric (0-9) keys**. **UP(↑)** or **DOWN(↓)** to change denom.

▶ Press **[START/ENTER]** key to save your settings. Machine is Ready to process your new Straps by dollar amount for all denom. banknotes and will display accumulated TOTAL at the end.

➤ How to Strap a specific Dollar amount (DSP mode)

Using "**DSP**" Mode, users can quickly Strap a specific Pre-set \$ Amount. Press **MODE** key until **DSP** appears. Press **BATCH** key and **DISPENSE** will appear on the screen. Type your amount and **START** key to save. To clear set amount, press **BATCH** →

