

AMROTEC®

User Manual V.1



CC-01

Portable Coin Counter

Preface

This guide provides information about the AMROTEC® Electronic coin counters. We recommend reading this guideline to learn how to use this machine. Then, as you become more familiar with this machine, use it as a reference guide to look up information when you need it.

CC-Series Coin Counters

Model	Coin Hopper approx	Speed approx	Off-Sorting	Conveyor Belt Driven	External Remote Display	Foot Paddle
CC-01	1500 dimes	3400 dimes	•	X	•	•
CC-03	4300 dimes	3400 dimes	•	•	•	•

FCC Compliance Statement

THIS DEVICE COMPLIES WITH PART 15 OF FCC RULES. OPERATION IS SUBJECT TO THE FOLLOWING CONDITIONS:

1. THIS DEVICE MAY NOT CAUSE HARMFUL INTERFERENCE, AND
2. THIS DEVICE MUST ACCEPT ANY INTERFERENCE RECEIVED, INCLUDING INTERFERENCE THAT MAY CAUSE UNDESIRED OPERATION.

FCC Notice

This equipment has been tested and found to comply with the limits for a Class A digital device, pursuant to part 15 of the FCC Rules. These limits are designed to provide reasonable protection against harmful interference when the equipment is operated in a commercial environment. This equipment generates, uses and can emit radio frequency energy and, if not installed and used in accordance with the instruction manual may cause harmful interference in radio communications. Operation of this equipment in a residence area is likely to cause harmful Interference in which case the user will be required to correct the interference at his own expense.

Changes or modifications of this product not expressly approved by Amro-Asian Trade, Inc., could void the user's authority to operate the equipment.

Table of Contents

Table of Contents	3
1. Introduction and intended use	4
Safety information	4
Warnings	4
2. Machine overview	5
Front / Rear view	5
User interface	6
Display	6
Key chart	6
3. Installation	7
Environment and working space	7
Bag, box installation	8
5. Coin preparation	11
6. Operation	11
Counting	11
Select Denomination	12
Memory	12
<i>Add Memory</i>	12
<i>Show Memory</i>	12
Bag Stop	13
<i>Select bag stop</i>	13
<i>Clear incomplete bag</i>	13
7. Setting menu	14
System Setting	14
Screen display	14
Counting mode	14
Batch selection	14
Deno/ Batch setting	14
8. Maintenance	15
10. Certifications	17
11. Specifications	18
12. Accessories	18

1. Introduction and intended use

Thank you for choosing the AMROTEC® CC-Series Coin Counter. The AMROTEC® coin counters are easy to use and offer broad functionality to accomplish a variety of low volume to heavy-duty coin processing tasks. This chapter introduces CC-series coin counters and provides you with a set of safety precautions to follow when installing and operating the machine.

An electric coin counter is mainly used for processing coins in financial institutions, vending businesses, amusement parks, payphone businesses, transportation companies, and other coin-op businesses.

CC-Series Electric Coin Counters count and separate all US coins at a fastest speed into a bag. You can also roll coins into standard paper wrapper using accessories provided with this machine. Two independent adjustment knobs on the machine allow users to select coin diameter and thickness for processed coins or to separate mixed coins.

Safety information

Always follow basic safety precautions when using this product to reduce risk of injury from fire or electric shock.

Observe all warnings and instructions marked on the product.

Do not install or use this device outdoors, near water, or when you are wet.

Install the product securely on a stable surface. See also chapter "Installation"

Do not exceed the specified load of the bag, given in chapter "Installation". Otherwise the machine can tilt and drop down.

Do not touch the coin disc when it is in operation. Take extra care of long hairs or loose clothing (e.g. tie). If it is caught in the machine, switch off the power immediately.

Unplug the CC-01 from wall outlets before cleaning.

Do not clean the machine with chemical cleaner and do not use blowing gas. Otherwise parts can be damaged or explosion / flash may occur.

If the product does not operate normally, see chapter "Troubleshooting".

Do not operate the machine when covers are removed. Servicing must be carried out by qualified service personnel.

Warnings

On the machine and in this manual standardized warning symbols are used. These are explained as followed:



Warning

Warning of possible danger, such as moving parts.



Electrical danger

Warning of possible injuries through electrical shocks



Risk of tilting

Warning of possible device tilting.

Do not exceed the weight of 9 kg in the counting bag and 7 kg in the reject bag. (see also Chapter "Installation")

2. Machine overview

Front / Rear view

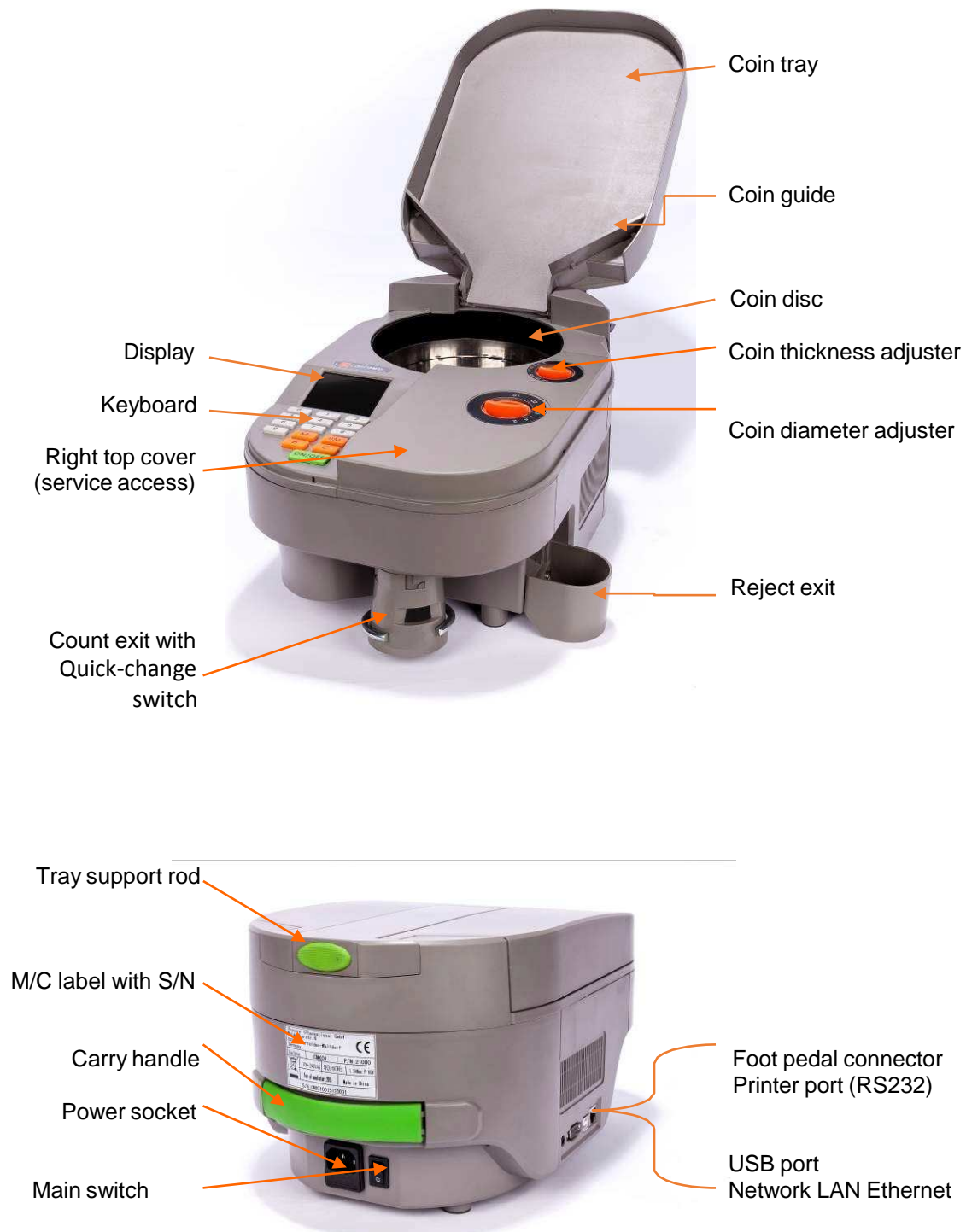

User interface

Display

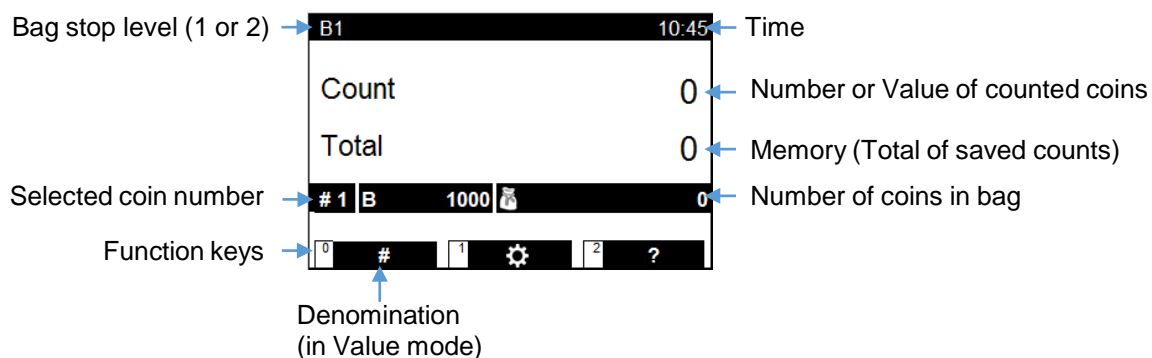

Key chart

Key	Description	Normal key stroke	3 seconds key stroke
ON/ OFF	Start/ Stop	Start or stop counting	
M	Add memory	Add the count to the memory	
RM	Print	Print ticket	
B	Batch stop	Set batch stop	Clear bag content
C	Clear	Delete count result and bag content	Delete memory
0	Denomination	Select new denomination or coin number. Show memory total.	
1	Setting	Enter setting menu	
2	Help	Show key functions	

3. Installation

Environment and working space

Make sure the environment does comply with the specifications given in chapter 1.1 and 11.

Make sure the CC-01 has proper electrical grounding.

The main fuse protection must be minimum 1,5A.

Install the CC-01 where no one can step on it or trip over the line cord, and the line cord cannot be damaged.

The seat area must be stable, solid, and smooth.

The bagging unit of the machine must protrude the table edge so that the connected bag hangs freely.

But take care that the front feet of the CC-01 remain in full size on the desk.

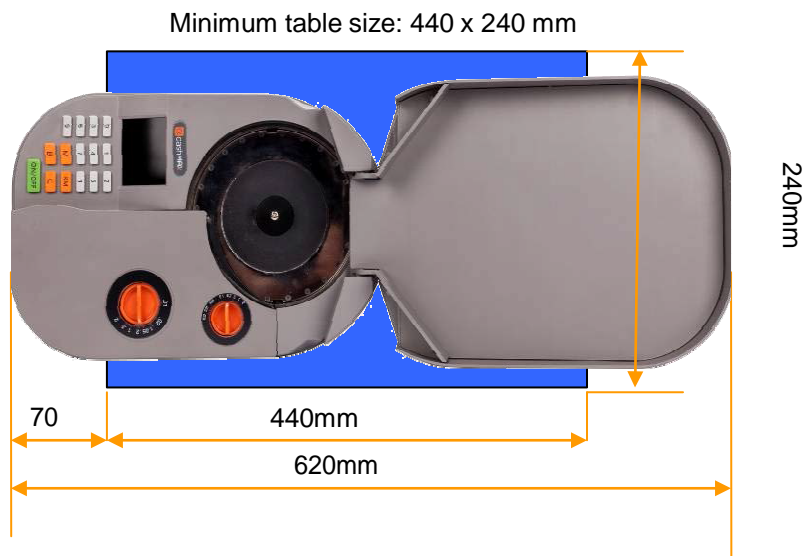
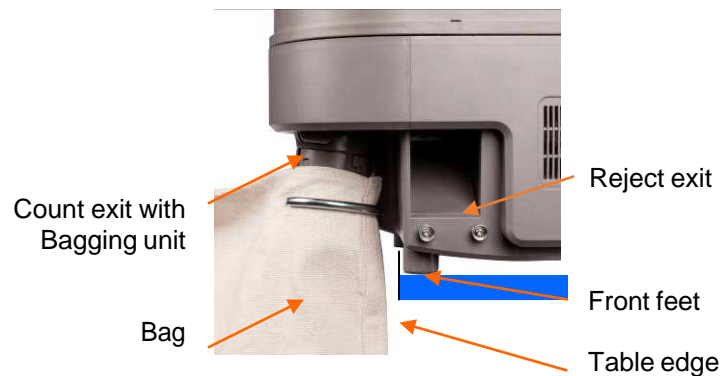

Bag, box installation

The CC-01 has one counting and one reject exit. The counting exit is provided to clamp a coin bag on it, but can be also used for the optional tubing kit. On the reject exit a cup or a bagging unit can be attached. When using the reject bagging unit the CC-01 must be placed on the left side of the desk, so the reject bag hangs freely.



Warning of possible device tilting.

Do not exceed the weight of 9 kg (about 1000x 2€ coins) in the counting bag and 7 kg (about 800x 2€ coins) in the reject bag. Install a support shelf where the bag rest on it, if higher weights are in use.

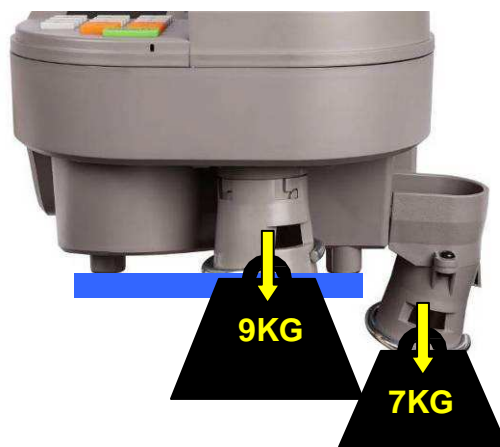

Connect the reject cup

or

reject bagging unit



A bag is fixed by: Move the metal ring upwards, wrap the bag around the tube and clamp it by moving down the ring.

4. Setting the coin size

Before you start counting, set always the thickness and diameter according the coin size you want to count.

Note: Smaller coins will be rejected but larger coins stay in the machine and may cause jams.



Thickness adjuster

Diameter adjuster

If tokens or other coins need to be count, those are not marked on the scale, set the correct size as follow:

a) Thickness

Open the right top cover. Turn the Thickness adjuster to maximum. Place the token under the thickness block and turn the adjuster slowly down until it gently touch the token. Turn the adjuster backward until the token moves freely, without resistance, between disc and thickness block



b) Diameter

Lift up the transport belt. Turn the Diameter adjuster to maximum. Place the token on the transport track and turn the adjuster slowly narrow until it gently touch the token. Turn the adjuster backward until the token moves freely and has side clearance of about 0.4 mm.

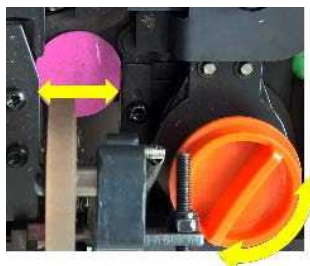
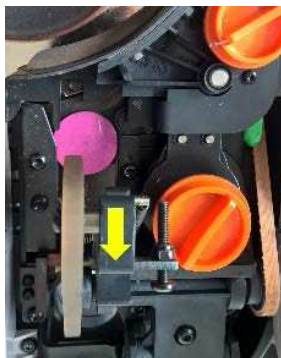

5. Coin preparation

Before loading coins into the machine inspect and remove all foreign objects. Also sort off damaged, lubricated or sticking coins.

- Insert the coin guides on the tray.
- Make sure the support rod of the tray is vertical aligned.

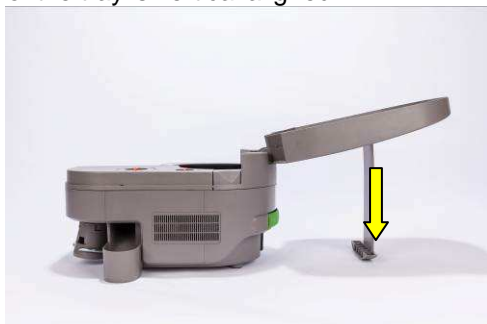

Warning of possible device tilting.

6. Operation

Before counting make always sure the selected settings, denominations and count memories meet your approbations.

Counting

Press “On/Off” key to start the count, or push the coin exit to activate the Quick-change switch. The CMX10 shows the counted quantity or value. When the count is finished the CMX10 stops automatically. (You can also press “On/Off” or push again the coin exit to stop the count manually.)

Piece counting

B1		10:45	
Count		100	
Total		0	
# 1	B	1000	100
0	#	1	2 ?

Value counting

B1		10:45	
Value		200.00	
Total		0.00	
#	B	1000	100
0	2.00	1	2 ?

or

It is now possible to

- RM: Print the count
- M: Save the count into the memory
- C: Clear the count and bag content
- C (long): Clear the count memory of this denomination
- On/Off: Count more coins

The CMX10 stops with “B1 Stop” if the pre-selected stop is reached. The count will automatically transferred to the memory and the bag content counter will set to zero. Replace the bag with an empty one.

Note: Value or piece counting is selectable in Setting menu, option “Counting mode”

Select Denomination

Adjust the thickness and diameter knob to the desired coin size and mount an empty coin bag on the counting exit.

Press the "0" key several times until the requested denomination / coin number appears.

If the count or bag content were not zero, there will be a warning message: "Are you sure you want to proceed". If you press "1" (Yes) the two counters will automatically cleared. With "2" (No) the coin number will not be changed.

After the last coin number "9" a total symbol "Σ" appears. It represents the sum of all saved counts and cannot be used for counting.

Memory

Add Memory

The CC-01 adds automatically full bags to the memory. When a count is finished and a bag stop is not reached, it is possible to accumulate the count to the memory by pressing "M". After pressing "M" the Count/ Value is reset to "0".

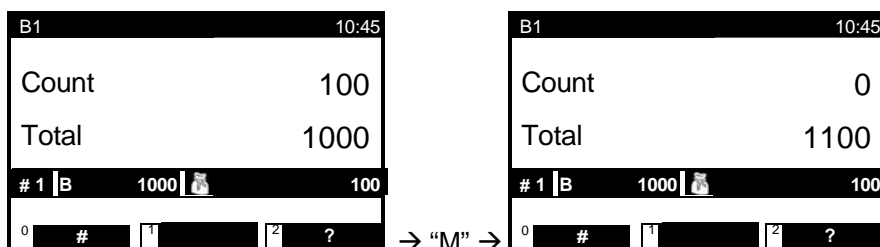

Show Memory

Press the "0" key several times until the Total symbol "Σ" appears. Here you can see the sum of all saved counts.

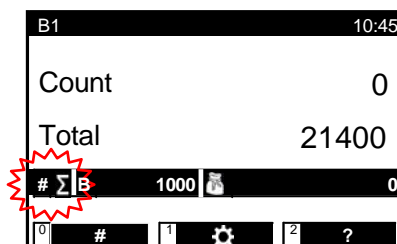

Press

RM: Print the total

C (long): Clear all totals

0: Select a denomination

Note: Uncomplete counts being not saved with "M" are not in the Memory

Bag Stop

Select bag stop

The CMX10 has three stop levels. The active stop level type is defined in the "Setting" menu.

Batch 1: Individual stop number for every denomination

Batch 2: One stop number for all denominations

Off: No stop

If Batch 1 or 2 is activated it is possible to change the pre-defined stop during normal count.

Press "B" and enter with the numeric keypad a new stop between 0...99999. Press "M" to save the new stop.

Alternative standard batch numbers (500, 1000, 2000, 5000, 10000) can be used by pressing "B" several times.



If you change a bag stop and the bag content is not zero, there will be a warning message "Do you want to clear count and bag?" Press "1" (Yes) to clear the two counters or "2" (No) to count further without clearing

Note: A steady stop in "Batch 1" must be entered in the Setting menu, option "Deno/Batch setting".

Clear incomplete bag

When you install an empty bag without a request of the CC-01, you must clear the Bag content. Otherwise the counter does not start with "0", which may lead to a wrong bag stop.

To delete the bag content hold the "B" key for about 3 seconds.

7. Setting menu

To enter the Setting menu press the “1” key. Use “0” to scroll up, “1” to scroll down and “2” to enter or change the selected option. To return to the main setting menu or go back to counting press the “On/Off” key.

10:45		
System Setting		
Screen display	B/W	
Counting mode	Pieces	
Batch selection	Batch 2	
Deno/ Batch setting		
0	s	1 t 2 4

System Setting

Currently there are three sub menus available.

10:45		
Alarm signal	On	
Date & Time		
Factory Default		
0	s	1 t 2 4

Alarm signal: ON (beep always) / Off (no beep) / Error (beep only by error)

Date & Time: Enter numbers with numeric keypad and press On/Off to save and exit

Factory Default: Press “2” and confirm with “1” to reset all settings (e.g. denom. values and bag stops)

Screen display

Press “2” to switch between Black&White and Colour display

Counting mode

Press “2” to change between Piece or Value counting

Batch selection

The CMX10 has three stop levels:

Batch 1: Individual stop number for every denomination

Batch 2: One stop number for all denominations

Off: No stop

Deno/ Batch setting

In this menu the coin values and batch stops of B1 are configured. Press

“0” to scroll through the channels

“1” to toggle between denomination and batch stop number

“2” to enter a new number

“M” to save a new number

10:45		
Channel	Denom	Batch1
1	10.00	20
2	5.00	20
3	2.00	20
4	1.00	25
5	0.50	50
0	s	1 U 2 4

8. Maintenance

For optimum performance and error free operation, cleaning must be performed regularly. High usage requires more frequent maintenance!

CAUTION: Always turn off and unplug the power cord before maintaining the CC-01.

Daily cleaning: Remove the dirt from the coin track. Wipe the dust away under the counting sensor. Use a soft brush and a lint-free cloth.

Open the right top cover and lift up the coin transport belt

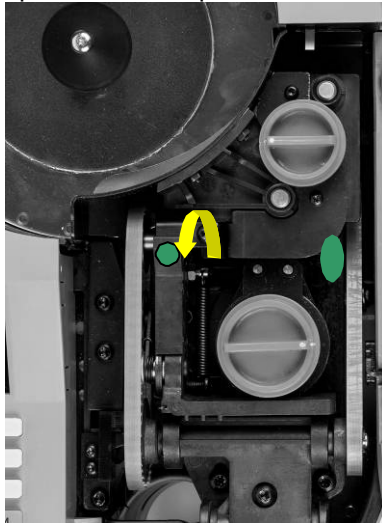

Move the lever to the right and remove the thickness block

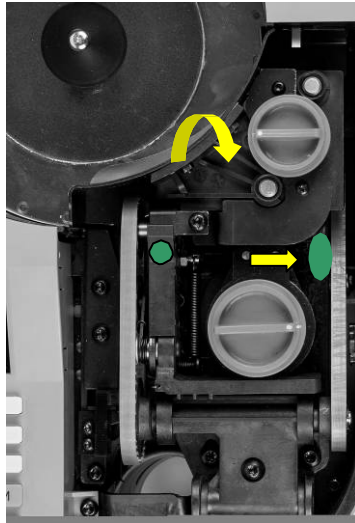

Clean disc, transport track, belt and sensor

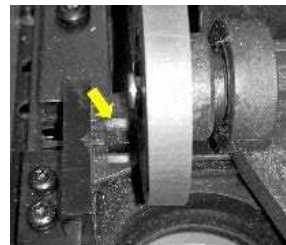
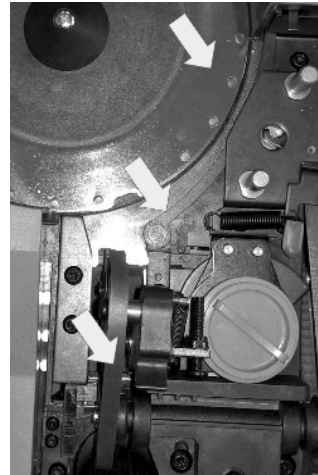

9. Troubleshooting

In case of an error event, the CC-01 stops and shows an error message. The messages and locations are explained below. When the error is solved, confirm the message and press On/Off to count further.

When the error appears repeatedly and you cannot fix that problem, please call the service and tell them the error message.

Pos	Error code	Error description	Removal
	Are you sure you want to proceed?	When selecting another coin number or denom., the current count and bag content will be deleted.	Press "1" (Yes) to change the denomination and delete the current count and coins in bag. Press "2" (No) to cancel the operation and count further or save the current denom.
	B1 (or 2) stop	The pre-set bag stop for the current coin number/denomination is reached.	Replace the bag. Press START or the Quick-change switch to count further. <i>Note: The complete count is automatically saved in the memory and the bag counter is set to zero.</i>
1	Coin under sensor	There are coins or foreign bodies jam under the coin counting sensor	Open the right top cover. Lift up the transport belt. Clean the count sensor and remove jammed objects. Control the coin diameter setting.
	Enter denom. value before	There is no value configured for the selected denomination	Select another denomination or enter a value in the "Deno/ Batch setting" menu.
	Motor does not start (w/o error message)	The total memory is selected.	Select a denomination with the "1" key.
	Please empty the bag	When clearing the count result, also the bag content will be set to zero.	Empty the bag. Press START or the Quick-change switch to repeat the count.
	Press "M" to save	To confirm and activate the new setting.	Press "M" to confirm and activate the new setting.
2	Side cover open	The right top cover is not closed.	Close the cover.
	To activate, count and bag will be cleared	A new bag stop was selected but the counters weren't zero.	Press "1" to clear the count and bag content. Press "2" to cancel. The stop before is still active.
3	Transport jam	The coin transport does not operate. Coins or foreign bodies jamming on the disc or under the transport belt.	Open the right top cover. Lift up the transport belt. Remove jammed objects. Control the coin diameter and thickness setting. Check that the motor switch is activated when the right top cover is closed.
	Value overflow. Clear counter.	The counted value or memory does exceed the maximum (99,999.99)	Print (if available) and then clear the counter or memory.

Error locations:

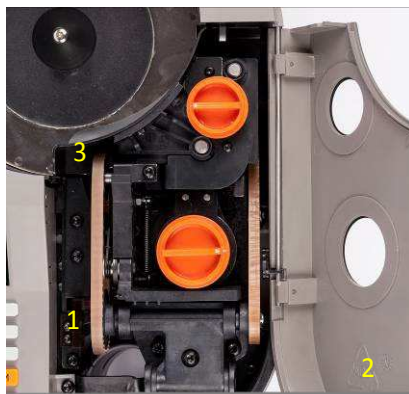

10. Certifications



This product meets furthermore the requirements of the EC directives

RoHS 2011/65/EC

WEEE 2002/96/EC

FCC

11. Specifications

Physical and electrical specifications		Features	
Mains input voltage	100 to 240 VAC, 50/60 Hz	Count modes	Piece and Value counting (all denominations, free programmable)
Power consumption	60 W Peak 22 W Operation 8 W Standby	Speed	Up to 3,400 coins per minute
Acoustic noise level	LpA < 79 dB(A) (uncertainty: 2) LpA Standby < 1 dB(A)	Chute hopper capacity	1,500 coins
Operating temperature	10°C to 35°C (50F – 95F)	Start/Stop	On/Off key Quick-change switch Foot pedal
Operating humidity	20% to 80% RH (non-condensing)	Bag stop	2 levels 0 – 99,999 coins Individual stop per denom.
Dimensions	Inch mm (closed)	Memory	Total and bag content
Height	7.5" 190		
Depth	13.9" 350		
Width	9.3" 235		
Weight	15.4lbs / 7.0 Kg	Connectivity	LAN (Ethernet), USB 2.0, RS232, Start/stop connector
Coin size range	Diameter: 14 - 34 mm Thickness: 0.8 – 3.8 mm	Software Update	SD-Card
Display	3" color LCD	Options	see "Accessories"

*** Specifications are subject to change without further notice.

12. Accessories

Included in delivery: Power cord, user manual, reject box and reject bagging unit. The following

accessories are orderable from your local dealer:

- 21001 Reject bagging attachment
- 21002 XXL auto-feed-hopper
- 21003 Tubing set
- 21004 Foot pedal
- 22305 Cleaning set

Limited Warranty, Disclaimer and Service:

Limited Warranty:

Congratulations on your purchase of our AMROTEC® CC-Series Electric Coin Counter. The manufacturer warrants this unit for a period of 90 days after the date of purchase against defects due to faulty workmanship or materials. This warranty does not cover normal wear of parts or damages resulting from any of the following: negligent use or misuse of the product, use on improper voltage or current, use contrary to operating instructions or disassembly, repair or alteration by any person other than an authorized technician or Service center.

Parts repair or replacement under this warranty is only provided upon presentation of reasonable evidence that the date of the claim is within the warranty period and warranty guideline has been satisfied. This warranty does not include any shipping cost and must be paid by customers. To obtain warranty support, repair, servicing, you may contact your distributor or sales representative of AMROTEC® CC-Series Electric Coin Counter.

Disclaimer:

Warranty remedies limited to only parts repair or replacement and done at our service center. Manufacturer, distributor, dealer or sales representatives of AMROTEC® CC-Series Coin Counter shall not be liable for any incidental or consequential damages for breach of any express or limited warranty on this products or any part thereof. Except to the extent prohibited by applicable law, manufacturer, distributor, dealers, sales representatives of AMROTEC® CC-Series Coin Counter disclaims any implied warranty or merchantability or fitness for a particular purpose of this product or any part thereof.

Service:

To obtain out of warranty repair or service on your AMROTEC® CC-Series Counter, contact your distributor or sales representative. Cost of the repair as well as any applicable shipping charges will be provided to you by them.

All product returned for service must contain a RMA number that will be supplied to you by the Customer Service Representative. NO PRODUCT WILL BE SERVICED WITHOUT A RMA NUMBER CLEARLY PLACED ON THE OUTSIDE OF THE SHIPPING CARTON. It is recommended that all products returned for service must be returned in the original packaging.

©2017 Amro-Asian Trade, Inc. USA

Printed in CHINA

January, 2017