

MiB-9 Exterior Description

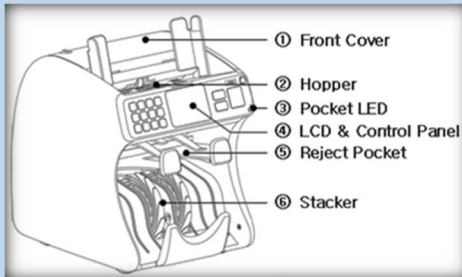

- 1) Front Cover
- 2) Hopper
- 3) Pocket LED
- 4) LED & Control Panel
- 5) Reject Pocket
- 6) Stacker
- 7) Currency Gate Adjustment Screw
- 8) Rear Cover Open handle
- 9) Power Switch
- 10) AC Inlet
- 11) RJ11 Port
- 12) LAN Port
- 13) RS232C Port (Serial)
- 14) USB Port
- 15) SD Card Slot

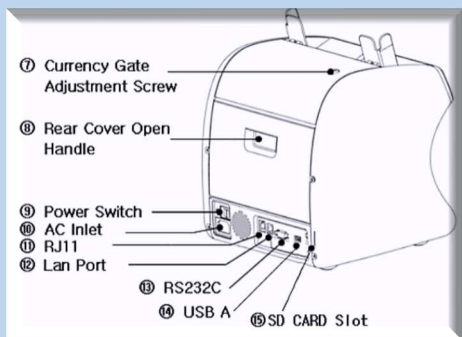

➤ Know how to place Banknotes onto Hopper correctly with Hopper Guides

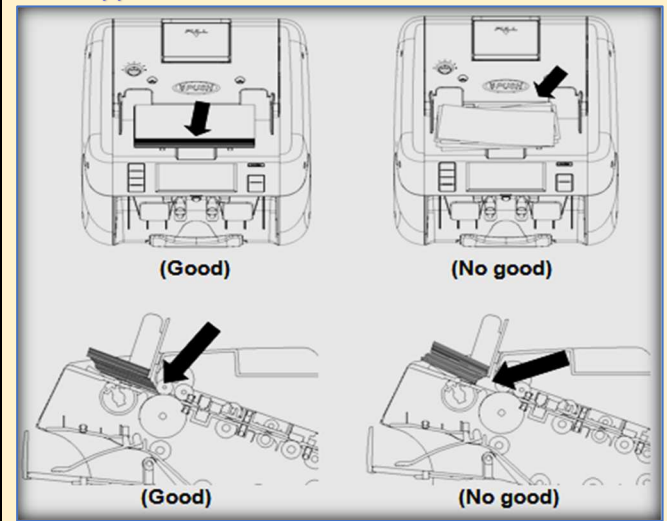

- ① Align banknotes nicely on each edge and place them in the Note hopper.
- ② Adjust Note guides to the dimension of your banknotes.

➤ Know important keys on Control Panel

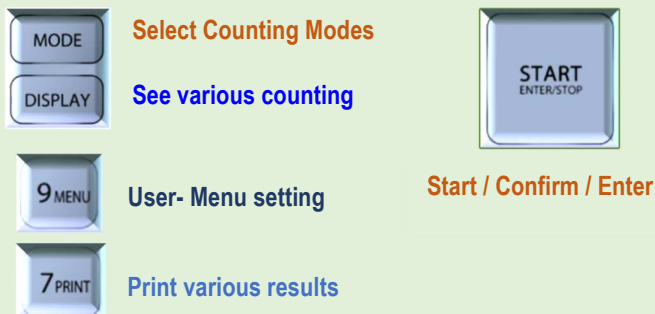

➤ How to switch to different counting modes?

➤ Press [MODE] key to enter MIXED → SINGLE → SORT → FACE → ORIENT → COUNT modes

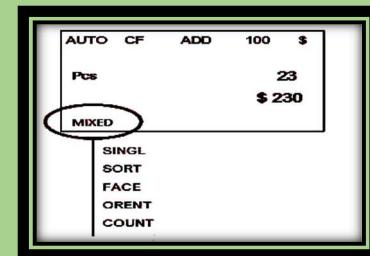

➤ How to select Automatic (Default) or Manual Count?

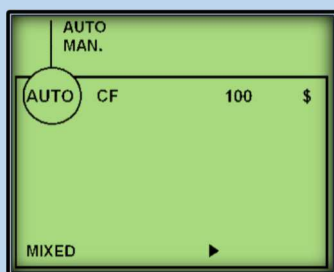

Press [MENU] key → **USER MENU → 4. SETTING → 4. AUTO START** (AUTO is Default).

If Manual Start is selected, top layer of the screen will show MAN.

➤ How to activate ADD function?

2 ADD ADD key is located on the right side of the control panel with numeric key 2. ADD function is to provide a cumulative count of continuous operation (multiple stack or banknotes) of processing banknotes.

➤ It is a useful function when an operator has lot of Stacks of banknotes to count and accumulates them to Total count or Grand total.

➤ Overview of LCD Display Screen:

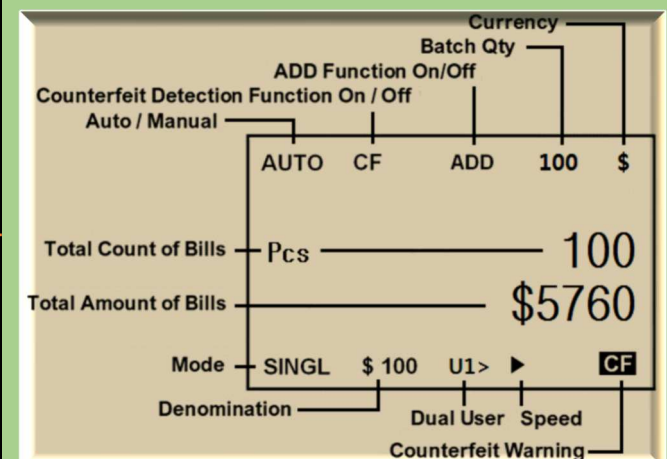

➤ How to switch to Multi-currency Count operation (if additional currency software is loaded)

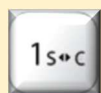

Press \$ ⇌ € key on the control panel to switch from one currency to another, let's say USD to Canadian currency.

➤ How to Auto-Print Receipt to a Printer?

User can set up Automatic printing of count result receipt by choosing Auto Printing ON. Machine will start printing as soon as banknotes are removed from Stacker.



Press **MENU** key → **USER MENU** → **5. PC Interface** → **1. SERIAL SET** →

AUTO PRINT

1. OFF
2. AFTER EMPTY HOPPER
3. PER EACH BATCH

AUTO PRINT → ON (choose after Empty Hopper)



➤ How to View Stacker count and Grand Total?

▶ Press **GT** key on the control panel to view total stacker count and Grand Total. To accumulate all counts into G.Total, **[PRINT] key must be pressed after every count is completed.**

▶ Press **GT** key → **[DISPLAY]** Key to view Grand Total details with denomination breakdown.

AUTO CF	100	\$
CURRENT STACKER		
\$	100	
GRAND TOTAL		
\$	100	

GRAND TOTAL :	0
\$ 1 :	295
\$ 2 :	0
\$ 5 :	1631
\$ 10 :	680
\$ 20 :	11855
\$ 50 :	12963
\$ 100 :	613

➤ How to set BATCH by Qty?

MiB-9 machine allows users to select counting of banknotes by a specific batch number (1-200) →



▶ Use numeric keys (0-9) on the control panel and then press **START / ENTER** key on the right side of the control panel to confirm the input.



▶ Press **Batch** Key again to deactivate. Batch number will disappear from top layer of the screen assuming deactivation of batch function.

➤ How to set and activate Denomination Batch (DB) for each denomination.



▶ To process each denomination of banknotes by a fixed pre-set batch number (**apply to SINGLE, and SORT Counting Mode**).

▶ **Setting:** Press **BATCH** key → until (DB) Denom. Batch appears on top layer of the display screen. By default, all denominations are set to 100.

▶ See next as to how to modify factory defaulted DB Batch setting to user's preference.

➤ How to enter into Denomination Batch (DB) setting for changes?

By default, all denominations are set to 100 under DB setting from factory. To make changes, enter into **USER MENU** → **8. SET SPECIAL FUNC.** → **4. DENOM. BATCH SET**



▶ User can modify these batch number for each denomination manually and save into Machine software by pressing **START/ENTER** when changes are done. Changes can be made by using of numeric keys (0-9) and scroll through by using of **UP(↑)** or **DOWN(↓)** key.

START: SAVE	MODE: ALL / DENOM
[ALL]	[---]
[\$1]	[100]
[\$2]	[100]
[\$5]	[100]
[\$10]	[100]
[\$20]	[100]
[\$50]	[100]
[\$100]	[100]

➤ Important Counting Modes and explanation:

▶ MIXED (As Default Mode)

When Mix mode is selected, Machine will count and denominate mixture denomination of banknotes.

▶ SINGL (SINGLE)

Machine counts and delivers first detected genuine banknotes as standard to Stacker and delivers rest to Reject Pocket.

▶ SORT (for Organized Strap)

Machine processes organized denominations in a strap of banknotes (Strap banknotes from POS cash drawers).

▶ FACE (Face-Direction)

Machine delivers first detected Face of banknote to Stacker and deliver reverse to Reject Pocket.

▶ ORENT (Orientation)

Machine delivers first detected Face-up in one orientation of banknote to Stacker and deliver reverse to Reject Pocket.

➤ How to perform Manual Entry Function for non-recognized genuine bills in reject pocket.

▶ After a count is completed and if there are genuine banknotes rejected for non-recognition, prior removing bills from Reject Pocket, press **[DISPLAY]** key twice to reach to Manual Entry input screen (Detail View) where user can make the addition of those banknotes and add to running total. **Press START/ENTER key to save your entry.**

REJ	1	COUNT	33
AMOUNT			155
\$	1	10 (00)	10
\$	2	0 (00)	
\$	5	21(01)	105
\$	10	0(02)	
\$	20	2(00)	40
\$	50	0(00)	
\$	100	0(00)	